

TOOLS & ACCESSORIES

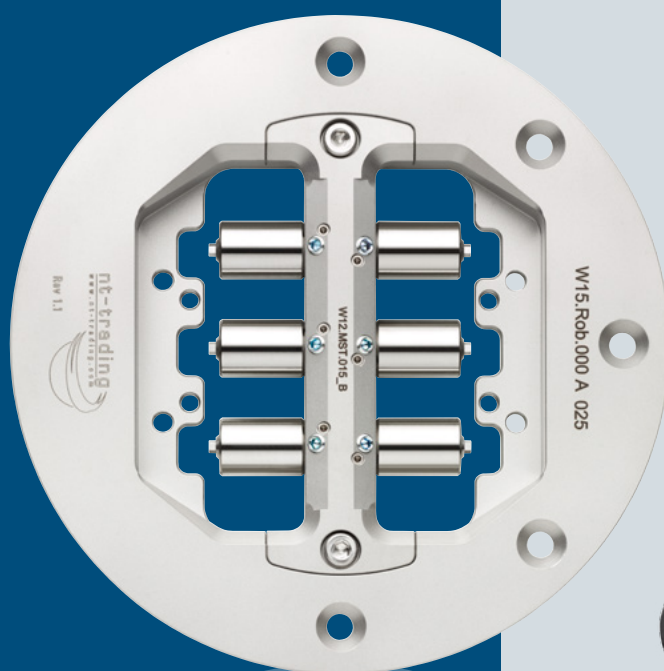

**PRECISION
MEETS QUALITY.**

**nt-Preform® HOLDER
AVAILABLE FOR THE
FOLLOWING CNC
MACHINE TYPES**

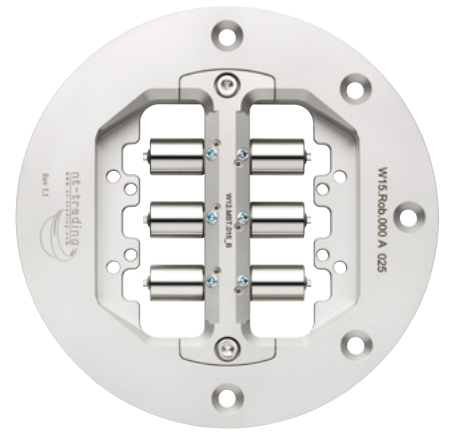

- Avamill-Chrome®
- Datron
- Dental concept systems®
- DMG Sauer ULTRASONIC 20®
- DMLS
- DooWoon
- Dyamach®
- GF Agie Charmilles Mikron HSM
- HAAS Automation
- HINT-ELS
- imes-icore®
- MANIX Dental
- MB Maschinen
- Organical
- PRIMACON
- Roboice Dental
- Röders
- VHF Camfacture
- Willemin-Macodel®
- Wissner
- yenadent
- Zfx









READ MORE



ACCESSORIES

nt-Preform® Accessories and Holder-Set



	Description	Art. No.
	Abutment grip Ø 3,5 mm	W 12.100.000
	Abutment grip Ø 4,3 mm	W 12.200.000
	Abutment grip Ø 5,0 mm	W 12.300.000
	Calibration pin for nt-Preform® holder imes-icore®	W 12.Ka0.000
	Calibration pin for nt-Preform® holder imes-icore® 140	W 12.Ka0.140
	Replacement of cover strip for abutment grip incl. 2 screws	W 12.CS0.000
	Replacement screws for holder contains: W 12.Sc1.000, W 12.Sc2.000 and grub screws for Abutment grip	W 12.Sc0.000
	Replacement screws for holder contains: W 12.We1.000, W 12.We2.000, W 12.We3.000	W 12.WS0.000
	Screwdriver incl. ISO-Shaft for Torque Ratchet for coloured milling screw THO-Series	W 11.THO.MIL

ABUTMENT GRIP YELLOW – 3,5 MM

W 12.100.000

READ MORE



Implant system	Compatibility	Art. No.
Altatec® / Camlog®	nt-Mill Lab Analog 3,3 mm	CAM 5.La3.300
Altatec® / Camlog®	nt-Mill Lab Analog 3,8 mm	CAM 5.La3.800
Altatec® / Conelog®	nt-Mill Lab Analog 3,3 mm	COL 5.La3.300
BEGO Implant Systems® / Semados® S, RS-RX, RI-Line	nt-Mill Lab Analog 3,25 / 3,75 mm	BEG 5.La3.237
BioHorizons® / internal	nt-Mill Lab Analog 3,0 mm	BIO 5.La3.000
BioHorizons® / internal	nt-Mill Lab Analog 3,5 mm	BIO 5.La3.500
Biomet 3i® / Certain®	nt-Mill Lab Analog 3,4 mm	H 5.La3.400
DENTSPLY Implants / Ankylos®	nt-Mill Lab Analog C/X	Y 5.La3.500
DENTSPLY Implants® / Astra Tech Implant System™ EV	nt-Mill Lab Analog 3,0 mm	SEV 5.La3.000
DENTSPLY Implants® / Astra Tech Implant System™ EV	nt-Mill Lab Analog 3,6 mm	SEV 5.La3.600
Dentsply-Friadent Frialit / Xive®	nt-Mill Lab Analog 3,4 mm	T 5.La3.400
DENTSPLY Implants® / Astra Tech Implant System OsseoSpeed® TX	nt-Mill Lab Analog 3,5 / 4,0 mm	S 5.La3.540
HIOSEN® / OSSTEM TS®	nt-Mill Analog 3,5 mm	HIO 5.La3.500
MIS® / C1®	nt-Mill Analog 3,3 mm	MIC 5.La3.300
MIS® / SEVEN®	nt-Mill Analog 3,3 mm	MIS 5.La3.300
Nobel Biocare™ / Brånemark®	nt-Mill Lab Analog 3,5 mm	K 5.La3.500
Nobel Biocare™ / Nobel Active™	nt-Mill Lab Analog 3,5 mm NP	F 5.La3.500
Nobel Biocare™ / Replace Select®	nt-Mill Lab Analog 3,5 mm NP	E 5.La3.500
Straumann® / Bone Level®	nt-Mill Lab Analog 3,3 mm NC	L 5.La3.300
Straumann® / SynOcta®	nt-Mill Lab Analog 3,5 mm NN	N 5.La3.500
Sweden & Martina Implantology™ / Premium Kohno®	nt-Mill Analog 3,3 mm	UPR 5.La3.300
Thommen Medical® / SPI®	nt-Mill Analog 3,5 mm	THO 5.La3.500
Zimmer Dental / Tapered Screw-Vent®	nt-Mill Lab Analog 3,5 mm	R 5.La3.500

ABUTMENT GRIP RED – 4,3 MM

W 12.200.000

READ MORE



System	Description	Art. No.
Altatec® / Camlog®	nt-Mill Lab Analog 4,3 mm	CAM 5.La4.300
Altatec® / Conelog®	nt-Mill Lab Analog 3,8 / 4,3 mm	COL 5.La3.843
BEGO Implant Systems® / Semados® S, RS-RX, RI-Line	nt-Mill Lab Analog 4,1 mm	BEG 5.La4.100
BioHorizons® / internal	nt-Mill Lab Analog 4,5 mm	BIO 5.La4.500
Biomet 3i® / Certain®	nt-Mill Lab Analog 4,1 mm	H 5.La4.100
Biomet 3i® / Osseotite® External Hex®	nt-Mill Lab Analog 4,1 mm	I 5.La4.100
Bredent Medical® / Sky®	nt-Mill Lab Analog 3,5 / 4,0 mm	BRE 5.La3.540
DENTSPLY Implants® / Astra Tech Implant System™ EV	nt-Mill Lab Analog 4,2 mm	SEV 5.La4.200
DENTSPLY Implants® / Astra Tech Implant System Osseo Speed® TX	nt-Mill Lab Analog 4,5 / 5,0 mm	S 5.La4.550
DENTSPLY Implants® / Xive®	nt-Mill Lab Analog 3,8 mm	T 5.La3.800
DENTSPLY Implants® / Xive®	nt-Mill Lab Analog 4,5 mm	T 5.La4.500
HIOSEN® / OSSTEM TS®	nt-Mill Analog 4,0-6,0 mm	HIO 5.La4.060
Medentis Medical® / ICX®	nt-Mill Analog 4,1 / 4,8 mm	MEX 5.La3.748
Megagen® AnyRidge®	nt-Mill Lab Analog 3,5-5,5 mm	MEG 5.La3.555
MIS® / C1®	nt-Mill Analog 3,75 / 4,2 mm	MIC 5.La3.742
MIS® / SEVEN®	nt-Mill Analog 3,75 / 4,2 mm	MIS 5.La3.742
NEOSS Implant System® / NEOSS™	nt-Mill Analog 3,5-5,5 mm	NEO 5.La3.555
Nobel Biocare™ / Brånemark®	nt-Mill Lab Analog 4,1 mm	K 5.La4.100
Nobel Biocare™ / Nobel Active™	nt-Mill Lab Analog 4,3 / 5,0 mm RP	F 5.La4.350
Nobel Biocare™ / Replace Select®	nt-Mill Lab Analog 4,3 mm RP	E 5.La4.300
Straumann® / Bone Level®	nt-Mill Lab Analog 4,1 / 4,8 mm RC	L 5.La4.148
Straumann® / SynOcta®	nt-Mill Lab Analog 4,8 mm RN	N 5.La4.800
Sweden & Martina Implantology™ / Premium Kohno®	nt-Mill Analog 3,8 mm	UPR 5.La3.800
Sweden & Martina Implantology™ / Premium Kohno®	nt-Mill Analog 4,25 mm	UPR 5.La4.200
Sweden & Martina Implantology™ / Premium TG®	nt-Mill Analog 3,3-4,25 mm	UTG 5.La3.342
Thommen Medical® / SPI®	nt-Mill Analog 4,0 mm	THO 5.La4.000
Thommen Medical® / SPI®	nt-Mill Analog 4,5 mm	THO 5.La4.500
Zimmer Dental / Tapered Screw-Vent®	nt-Mill Lab Analog 4,5 mm	R 5.La4.500

ABUTMENT GRIP BLUE – 5,0 MM

W 12.300.000

READ MORE



System	Description	Art. No.
Altatec® / Camlog®	nt-Mill Lab Analog 5,0 mm	CAM 5.La5.060
Altatec® / Conelog®	nt-Mill Lab Analog 5,0 mm	COL 5.La5.000
BEGO Implant Systems® / Semados® S, RS-RX, RI-Line	nt-Mill Lab Analog 4,5 mm	BEG 5.La4.500
BEGO Implant Systems® / Semados® S, RS-RX, RI-Line	nt-Mill Lab Analog 5,5 mm	BEG 5.La5.500
Biomet 3i® / Certain®	nt-Mill Lab Analog 5,0 mm	H 5.La5.000
BioHorizons® / internalz	nt-Mill Lab Analog 5,7 mm	BIO 5.La5.700
DENTSPLY Implants® / Astra Tech Implant System™ EV	nt-Mill Lab Analog 4,8 mm	SEV 5.La4.800
DENTSPLY Implants® / Astra Tech Implant System™ EV	nt-Mill Lab Analog 5,4 mm	SEV 5.La5.400
DENTSPLY Implants® / Xive®	nt-Mill Lab Analog 5,5 mm	T 5.La5.500
MIS® / C1®	nt-Mill Analog 5,0 mm	MIC 5.La5.000
MIS® / SEVEN®	nt-Mill Analog 5,0 mm	MIS 5.La5.000
Nobel Biocare™ / Brånemark®	nt-Mill Lab Analog 5,1 mm	K 5.La5.100
Nobel Biocare™ / Replace Select®	nt-Mill Lab Analog 5,0 mm WP	E 5.La5.000
Straumann® / SynOcta®	nt-Mill Lab Analog 6,5 mm WN	N 5.La6.500
Sweden & Martina Implantology™ / Premium Kohno®	nt-Mill Analog 5,00 mm	UPR 5.La5.000
Sweden & Martina Implantology™ / Premium TG®	nt-Mill Analog 5,0 mm	UTG 5.La5.000
Thommen Medical® / SPI®	nt-Mill Analog 5,0 mm	THO 5.La5.000
Thommen Medical® / SPI®	nt-Mill Analog 6,0 mm	THO 5.La6.000
Zimmer Dental / Tapered Screw-Vent®	nt-Mill Lab Analog 5,7 mm	R 5.La5.700

READ MORE



SURGICAL GUIDE SLEEVES



BENEFITS

- sleeve positioning by retentive fixture, no gluing necessary
- easy and precise sleeve placement in the surgery guide by using the NT-positioning tool
- the optimized sleeve design also allows the usage in narrow interdental spaces
- a drill mark on the sleeves upper edge facilitates the alignment when inserting into the surgery guide
- NT-trading drill sleeves are released for application in 3shape® Implant Studio and exoplan Guide Creator

APPLICATION

- for preparing the implant bed by using implant surgical drills
- compatible to the appropriate implant surgery sets

TECHNICAL DETAILS

- Titanium Grade 5 ELI

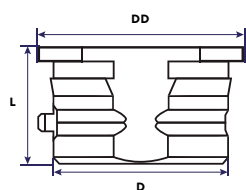
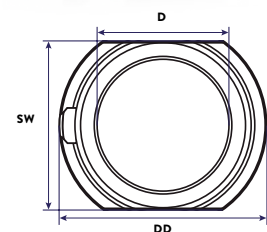

d = Inner Diameter
D = Outer Diameter
DD = Tread Diameter
L = Length
SW = Width











Notice: Products indicated with ® and ™ are registered brand names of the respective manufacturer.

SURGICAL GUIDE SLEEVES





READ MORE



SURGICAL GUIDE SLEEVES

	System	d	D	DD	L	SW	Art. No.
	Nobel Biocare™ NP	Ø 4,10 mm	Ø 4,80 mm	Ø 5,80 mm	4,00 mm	4,50 mm	SGS 16.SD4.148
	Nobel Biocare™ RP	Ø 5,00 mm	Ø 6,00 mm	Ø 7,00 mm	4,00 mm	5,70 mm	SGS 16.SD5.060
	Nobel Biocare™ WP	Ø 6,20 mm	Ø 7,00 mm	Ø 8,00 mm	4,00 mm	6,70 mm	SGS 16.SD6.270
	Camlog®	Ø 3,50 mm	Ø 4,80 mm	Ø 5,80 mm	3,00 mm	4,50 mm	SGS 16.SD3.548
	Camlog®	Ø 4,50 mm	Ø 6,00 mm	Ø 7,00 mm	3,00 mm	5,70 mm	SGS 16.SD4.563
	Ankylos® / Xive® ND	Ø 4,48 mm	Ø 6,00 mm	Ø 7,00 mm	4,00 mm	5,70 mm	SGS 16.SD4.560
	Ankylos® WD	Ø 4,90 mm	Ø 6,00 mm	Ø 7,00 mm	4,00 mm	5,70 mm	SGS 16.SD4.960
	Xive® WD	Ø 5,20 mm	Ø 6,00 mm	Ø 7,00 mm	4,00 mm	5,70 mm	SGS 16.SD5.260
	Straumann®	Ø 5,00 mm	Ø 6,00 mm	Ø 7,00 mm	4,00 mm	5,70 mm	SGS 16.SD5.060
	Astra Tech Implant System®	Ø 4,70 mm	Ø 6,00 mm	Ø 7,00 mm	4,00 mm	5,70 mm	SGS 16.SD4.760
	Astra Tech Implant System®	Ø 5,70 mm	Ø 7,00 mm	Ø 8,00 mm	4,00 mm	6,70 mm	SGS 16.SD5.770

SINGLE SLEEVES FOR PILOT DRILL

	System	d	D	DD	L	SW	Art. No.
	Pilot drill 2,0 mm	Ø 2,00 mm	Ø 3,20 mm	Ø 4,20 mm	4,00 mm	2,90 mm	SGS 16.PD2.032
	Pilot drill 2,2 mm	Ø 2,20 mm	Ø 3,20 mm	Ø 4,20 mm	4,00 mm	2,90 mm	SGS 16.PD2.232
	Pilot drill 2,3 mm	Ø 2,35 mm	Ø 3,20 mm	Ø 4,20 mm	4,00 mm	2,90 mm	SGS 16.PD2.332
	Pilot drill 2,8 mm Straumann®	Ø 2,80 mm	Ø 4,80 mm	Ø 5,80 mm	4,00 mm	4,50 mm	SGS 16.PD2.848

d = Inner Diameter | D = Outer Diameter | DD = Tread Diameter | L = Length | SW = Width



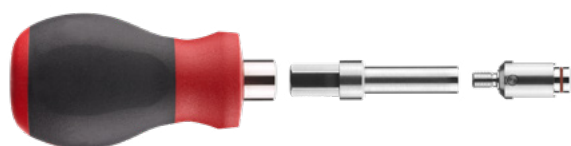













TOOLS



READ MORE



SURGICAL GUIDE SLEEVE TOOL

	Name	System	d	Art. No.
	Handle	universal	—	W 16.SGS.000
	Blade	universal	—	W 16.SGS.100
	SGS Positioning Tool	Pilot drill 2,0 mm	Ø 2,00 mm	W 16.SGS5.120
	SGS Positioning Tool	Pilot drill 2,2 mm	Ø 2,20 mm	W 16.SGS5.122
	SGS Positioning Tool	Pilot drill 2,3 mm	Ø 2,35 mm	W 16.SGS5.123
	SGS Positioning Tool	Pilot drill 2,8 mm Straumann®	Ø 2,80 mm	W 16.SGS5.228
	SGS Positioning Tool	Camlog®	Ø 3,50 mm	W 16.SGS5.235
	SGS Positioning Tool	Nobel Biocare™ NP	Ø 4,10 mm	W 16.SGS5.241
	SGS Positioning Tool	Ankylos® / Xive® ND	Ø 4,48 mm	W 16.SGS5.345
	SGS Positioning Tool	Camlog®	Ø 4,50 mm	W 16.SGS5.345
	SGS Positioning Tool	Astra Tech Implant System®	Ø 4,70 mm	W 16.SGS5.347
	SGS Positioning Tool	Ankylos® WD	Ø 4,90 mm	W 16.SGS5.349
	SGS Positioning Tool	Nobel Biocare™ RP	Ø 5,00 mm	W 16.SGS5.350
	SGS Positioning Tool	Straumann®	Ø 5,00 mm	W 16.SGS5.350
	SGS Positioning Tool	Xive® WD	Ø 5,20 mm	W 16.SGS5.352
	SGS Positioning Tool	Astra Tech Implant System®	Ø 5,70 mm	W 16.SGS5.457
	SGS Positioning Tool	Nobel Biocare™ WP	Ø 6,20 mm	W 16.SGS5.462

d = Inner Diameter

TOOLS & ACCESSORIES

Notice: Products indicated with © and ™ are registered brand names of the respective manufacturer.
For products available in the USA, please check our website: www.nt.dental/en/

 MADE IN GERMANY

WWW.NT.DENTAL

READ MORE



TOOL SET

The multi-piece tool set includes a torque ratchet, insert-holder for inserts and different inserts.





Torque Ratchet

continuously adjustable to max. 40 Ncm
ISO-Shaft connection

W1100001F



Insert-Holder

for changeable inserts (without ISO-Shaft)
ISO-Shaft connection

W 11.100.000



Insert

for Insert-Holder and Torque Ratchet
ISO-Shaft for MEX-Series

W 11.MEX.G01



Insert

for Insert-Holder and Torque Ratchet
ISO-Shaft for NEO-Series

W 11.NEO.G02



Insert

for Insert-Holder and Torque Ratchet
ISO-Shaft for SEV-, UPR- and UTG-Series

W 11.SMU.G03



Insert

for Insert-Holder and Torque Ratchet
ISO-Shaft for THO-Series

W 11.THO.G04



Insert

for Insert-Holder and Torque Ratchet
ISO-Shaft for BEG-, BIO-, I-, MIC-, MIS-,
R- and S-Series

W 11.IRS.G10

TOOLS

READ MORE



Insert

for Insert-Holder and Torque Ratchet
ISO-Shaft for T-, H-, CAM-, COL-, HIO-, MEG-
Series and DIM-ANALOG® counter screw

W 11.THC.G20



Insert

for Insert-Holder and Torque Ratchet
ISO-Shaft for Y-Series

W 11.Y00.G30



Insert

for Insert-Holder and Torque Ratchet
ISO-Shaft for BRE-, L- and N-Series,
2-CONnect® Coping screws Torx T6

W 11.LN0.G40



Insert

for Insert-Holder and Torque Ratchet
ISO-Shaft for E-, F- and K-Series

W 11.EFK.G50



Insert

for Insert-Holder and Torque Ratchet
ISO-Shaft for 2-CONnect®-Male Part straight

W 11.005.G60



Insert

for Insert-Holder and Torque Ratchet
ISO-Shaft for Validation Jig

W 11.VAL.G70



Insert

for Insert-Holder and Torque Ratchet ISO-Shaft
for Validation Jig, ball head

W 11.VAL.G75



Tool Set

The multi-piece tool set includes a torque ratchet,
a insert-holder and different inserts.

W11000PSB

READ MORE



SCREWDRIVER -SET

The multi-part screwdriver set includes different screwdrivers for fastening abutment screws.



SCREWDRIVER

READ MORE

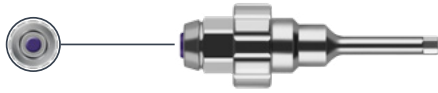

Screwdriver
incl. ISO-Shaft for Torque Ratchet
for 2-CONnect®-Male Part

W 11.2CO.NM0

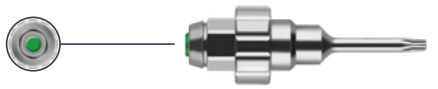

Screwdriver
incl. ISO-Shaft for Torque Ratchet
for E-, F- and K-Series UG

W 11.EFK.000

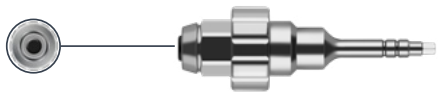

Screwdriver
incl. ISO-Shaft for Torque Ratchet
for BEG-, BIO-, I-, MIC-, MIS-, R- and S-Series

W 11.IRS.000

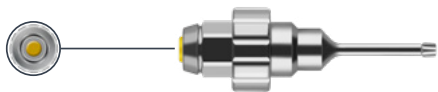

Screwdriver
incl. ISO-Shaft for Torque Ratchet
for BRE-, L- and N-Series, 2-CONnect®
Coping screws Torx T6

W 11.LN2.COF

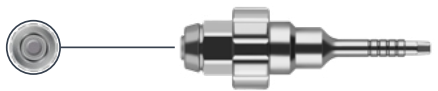

Screwdriver
incl. ISO-Shaft for Torque Ratchet
for MEX-Series

W 11.MEX.000

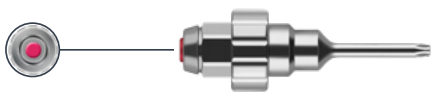

Screwdriver
incl. ISO-Shaft for Torque Ratchet
for NEO-Series

W 11.NEO.000

SCREWDRIVER

READ MORE

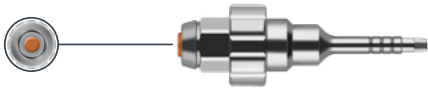

Screwdriver
incl. ISO-Shaft for Torque Ratchet
for SEV-, UPR- and UTG-Series

W 11.SEV.SMU

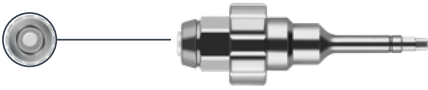

Screwdriver
incl. ISO-Shaft for Torque Ratchet
for T-, H-, CAM-, COL-, HIO-, MEG-Series
and DIM-ANALOG® counter screw

W 11.THC.DIM

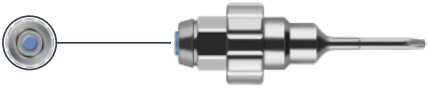

Screwdriver
incl. ISO-Shaft for Torque Ratchet
for THO-Series

W 11.THO.000



Screwdriver
incl. ISO-Shaft for Torque Ratchet
for coloured nt-milling screw THO-Series

W 11.THO.MIL

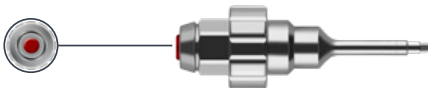

Screwdriver
incl. ISO-Shaft for Torque Ratchet
for Y-Series

W 11.Y00.000



Screwdriver-Set
The multi-part screwdriver set includes different
screwdrivers for fastening abutment screws.

W 11.000.SET
(6 / 11 pieces)

EUROPE

NT-Trading GmbH & Co. KG

G.-Braun-Str. 18
76187 Karlsruhe
Germany

P +49 721 961 999-0

E info@nt.dental

W www.nt.dental

NORTH AMERICA

NT-US, Inc.

132 Pepes Farm Road,
Unit 3
Milford, CT 06460
USA

E info@nt.dental (general information)

E order-us@nt.dental (for orders)

W www.nt.dental

2023_NT_ACCESSORIES&TOOLS_EN_REV01